

SHEET 4

THE ENGINEER'S RESPONSIBILITY OF THE TOWNSHIP ENGINEER OF TOWNSHIP LOCAL GOVERNMENT IS APPROVED AS A TAX MAP PURSUANT TO THE PROVISIONS OF CHAPTER 175, L.A.S. OF 1911, ETC. FOR THE TOWNSHIP, DIVISION OF TOWNSHIP

Albert A. Fralinger, Jr. P.E. & L.S.
 N. J. LIC. # 12588 CHIEF ENGINEERING SECTION

APR 16 1988 SERIAL NO. 620

TAX ASSESSMENT MAP
 DOWNE TOWNSHIP
 CUMBERLAND COUNTY, N.J.
 SCALE: 1" = 100' OCTOBER 1988
 ALBERT AFRALINGER, JR., P.E. & L.S.
 N. J. LIC. # 12588 TOWNSHIP ENGINEER
 629 SHILOH PIKE, BRIDGETON N. J. 08302

SHEET 4

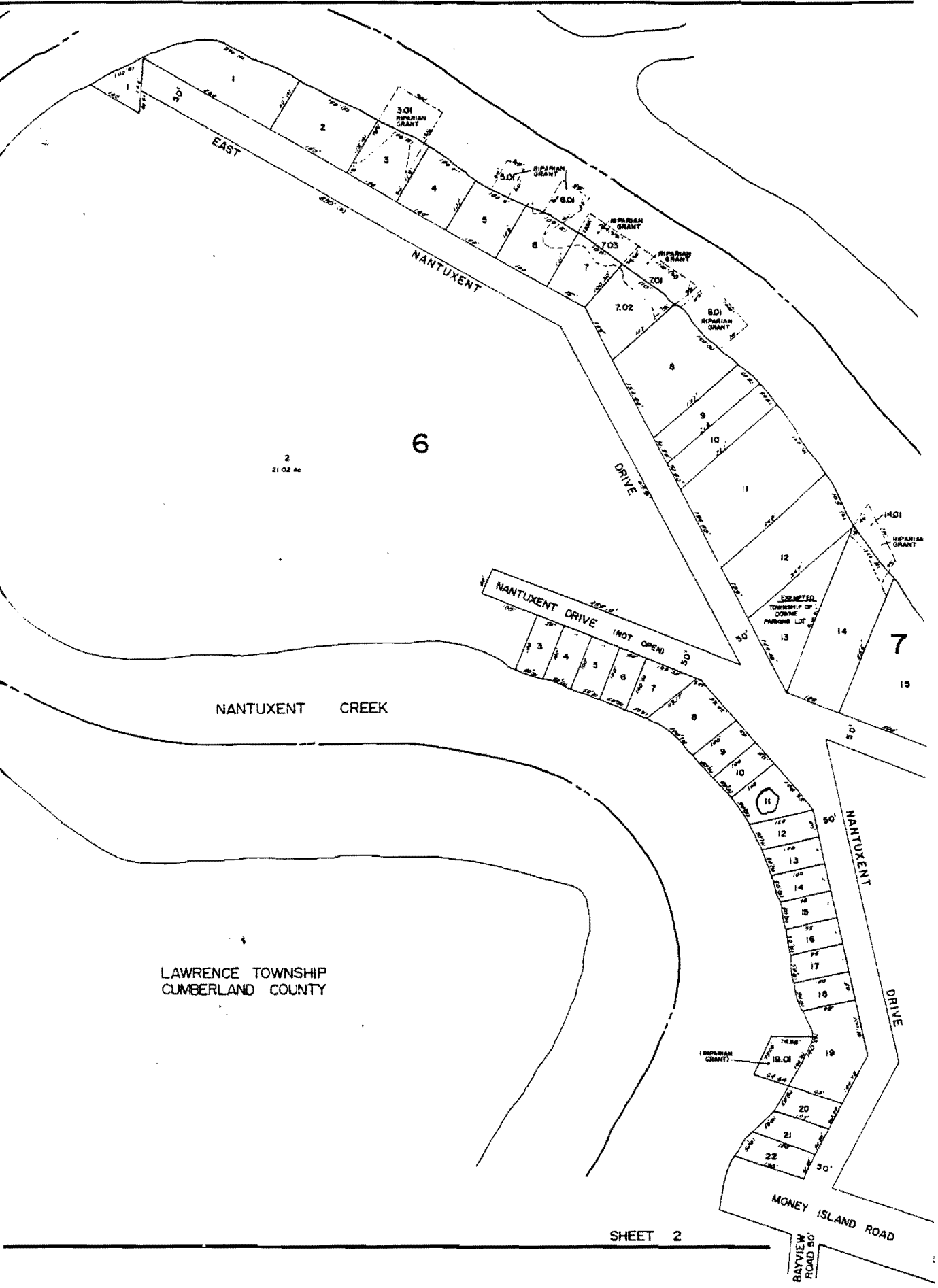

LAWRENCE TOWNSHIP
CUMBERLAND COUNTY

SHEET 2